

HOW TO USE YOUR



BATH SEAT W/ARMS & HYG FRONT

Item # 9039

Capacity not to exceed 300lb



No Tools
Required



Quick
Installation

WHAT'S INCLUDED

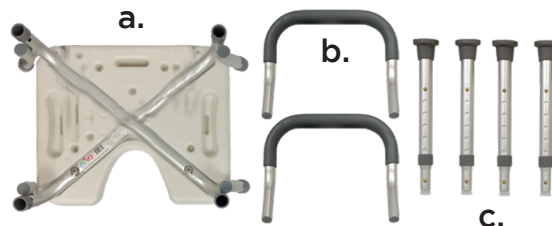

- 1 Place the seat face down on a level surface. Insert the four legs into the tubing holes. Depress the push button and push the tube in until the button “clicks” and locks into position (see **Figure 1**).



Figure 1

- 2 Place the chair upright so that it is resting evenly on all four legs and insert the arms into the frame. Depress both push buttons and push down until the push buttons “click” and lock into position. Repeat this step for the opposite arm (see **Figure 2**).

NOTE: Arms should curve inwards towards each other.

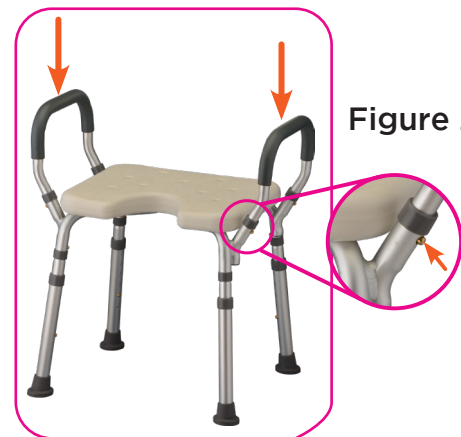

Figure 2

- 3 Use the push buttons and numbered holes to adjust the seat to the desired seat height. Ensure the Bath Seat is level, stable, and all push buttons are fully engaged before using (see **Figure 3**).

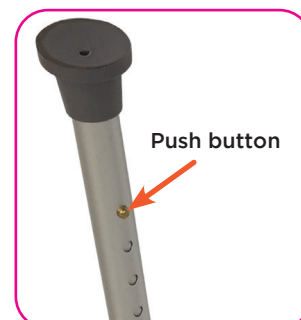

Figure 3

WARNING

Read all instructions carefully. Failure to do so may result in serious injury.

- Ensure ALL leg push buttons are engaged before using
- All legs MUST be adjusted to the same height to ensure level seating and safety
- Use EXTREME caution on wet tub or floor surfaces
- DO NOT stand on bath bench
- DO NOT use if the bath bench is damaged. Check frequently for cracks, damage, or looseness.
- This product is rated for persons weighing up to 300 lb when properly assembled



CARE AND MAINTENANCE

Regular cleaning is recommended. Use a non abrasive cleaner or detergent, rinse with warm water and dry completely. Abrasive cloths may damage the surface.

WARRANTY INFORMATION

NOVA stands firm on our commitment to providing the highest quality products, as well as exceptional service. This product was built to precise standards and thoroughly inspected prior to shipment. This warranty represents our confidence in the materials and workmanship of our product.

NOVA extends this warranty only to the original purchaser of this product. The warranty does not extend to any subsequent purchaser or owner. The warranty is void upon any sale or transfer of ownership or use by other person. NOVA warrants its products are free from defects in material and workmanship under NORMAL use for the period commencing upon the date of purchase and continuing for the following specified period of time after that date:

Metal Frame

Non-Metal/Metal parts

Limited Lifetime Warranty

One Year Limited Warranty

(rubber tips, plastic or metal hardware)

This warranty does not cover problems due to user negligence, misuse of the product, failure to adhere to product instructions, or normal wear and tear. Items that have been subject to negligent abuse, modified without prior written authorization are not covered within this warranty.

For warranty service, please contact the dealer from whom you purchased your NOVA product. In the event that you do not receive satisfactory service, please call us directly at the number on the bottom front of this sheet. Be prepared to indicate, the nature of the defect, the product serial number, and the name and location of where you purchased the product. You will also be required to provide a receipt of your purchase. Do not return any products to our office without prior consent.

Repair or replacement is the only remedy under this limited warranty. This warranty does not include any labor or shipping charges incurred in replacement part installation or repair of product.

THIS WARRANTY IS EXCLUSIVE AND IN LIEU OF ALL OTHER EXPRESS WARRANTIES, IMPLIED WARRANTIES, IF ANY, INCLUDING THE IMPLIED WARRANTIES OF MERCHANTABILITY AND FITNESS FOR A PARTICULAR PURPOSE. NOVA SHALL NOT BE LIABLE FOR ANY SEQUENTIAL OR INCIDENTAL DAMAGES WHATSOEVER.

IMPORTANT WARNING

FOLLOW ALL DIRECTIONS CAREFULLY BEFORE USE. FAILURE TO DO SO MAY RESULT IN SERIOUS INJURY.

CONTACT US!
We're here to help

 info@novajoy.com

 1 800 557 6682

novajoy.com

Connect with us!

novajoy.com

 [novamedicalprod](#)

 [novamedicalprod](#)

 [novawalkerstalk](#)

 [NOVA Medical Products](#)

CARE • QUALITY • INNOVATION



THE **NOVA** PROMISE